

■ DROP FORGED BOLT TYPE ANCHOR SHACKLE

**S.S. T316
DROP FORGED**

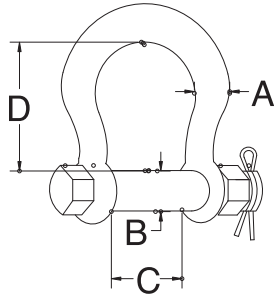

ITEM	A	B	C	D	WLL (lb)	WT (lb)
2711SF-BB-06	1/4"	5/16"	15/32"	1-1/16"	1,000	0.10
2711SF-BB-08	5/16"	3/8"	1/2"	1-1/4"	1,300	0.18
2711SF-BB-10	3/8"	7/16"	5/8"	1-7/16"	1,500	0.30
2711SF-BB-12	7/16"	1/2"	3/4"	1-5/8"	2,000	0.50
2711SF-BB-13	1/2"	5/8"	7/8"	1-7/8"	3,000	0.72
2711SF-BB-16	5/8"	3/4"	1-1/16"	2-5/16"	4,000	1.40
2711SF-BB-20	3/4"	7/8"	1-1/4"	2-7/8"	6,000	2.30
2711SF-BB-22	7/8"	1"	1-1/2"	3-5/16"	8,000	3.65
2711SF-BB-25	1"	1-1/8"	1-5/8"	3-3/4"	10,000	5.20
2711SF-BB-32	1-1/4"	1-3/8"	2-1/8"	4-5/8"	15,000	9.90

DIMENSIONS MEET FED.SPEC.:RR-C-271D,TYPE IV A, CLASS 2

Breaking strength is 5 times of the WLL; Proof test load is 2 times of the WLL.