

BOLT PIN ANCHOR SHACKLE

S.S. T316
PRECISION CAST LOAD RATED

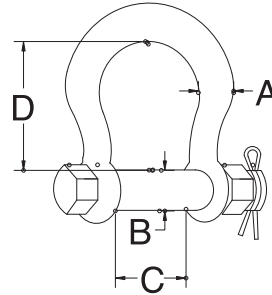

ITEM	A	B	C	D	WLL (lb)	WT (lb)
2711S-BB-05	3/16"	1/4"	3/8"	7/8"	650	0.06
2711S-BB-06	1/4"	5/16"	15/32"	1-1/16"	880	0.12
2711S-BB-08	5/16"	3/8"	1/2"	1-1/4"	1,300	0.20
2711S-BB-10	3/8"	7/16"	5/8"	1-7/16"	1,500	0.30
2711S-BB-12	7/16"	1/2"	3/4"	1-5/8"	2,000	0.45
2711S-BB-13	1/2"	5/8"	7/8"	1-7/8"	3,000	0.70
2711S-BB-16	5/8"	3/4"	1-1/16"	2-5/16"	4,000	1.30
2711S-BB-20	3/4"	7/8"	1-3/16"	2-7/8"	6,000	2.30
2711S-BB-22	7/8"	1"	1-1/2"	3-7/16"	8,000	3.40
2711S-BB-25	1"	1-1/8"	1-5/8"	3-3/4"	10,000	4.80
2711S-BB-32	1-1/4"	1-3/8"	2-1/8"	4-5/8"	14,000	11.00

DIMENSIONS MEET FED. SPEC.:RR-C-271D, TYPE IV A, CLASS 3

Breaking strength is 4 times of the WLL; Proof test load is 1.5 times of the WLL.