

CROSS CABLE CLIP

S.S. T316 MACHINED

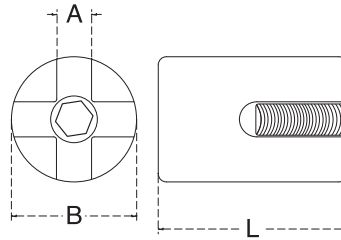

ITEM	A (WIRE)	B	L
263S-03	1/8"	3/4"	7/8"
263S-04	5/32"	3/4"	7/8"
263S-05	3/16"	3/4"	7/8"
263S-06	1/4"	3/4"	1"

CROSS CABLE CLIP SHOULD BE USE ON LONGER CABLE FOR MORE SUPPORT.